



Support

unit for encoders with damping elements

- Protects the encoder from high radial- and axial loads.
- Suitable for encoders with 10mm axle

Rugged design

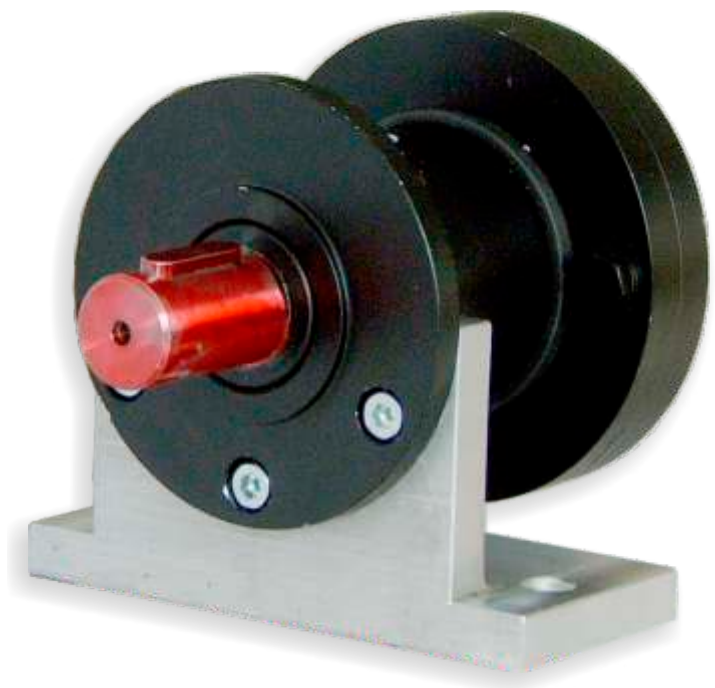

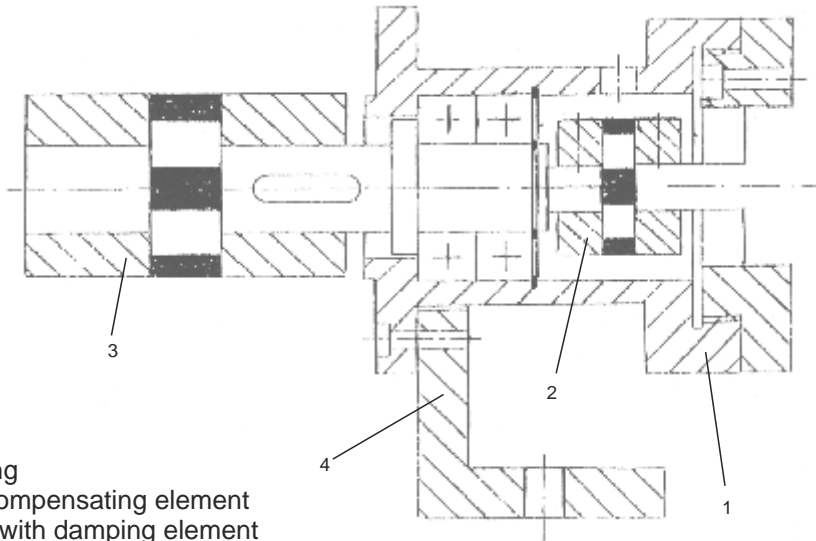

Support

- 1. Bearing housing
- 2. Coupler with compensating element
- 3. Claw coupling with damping element
- 4. Fastening angle

Dimensions:

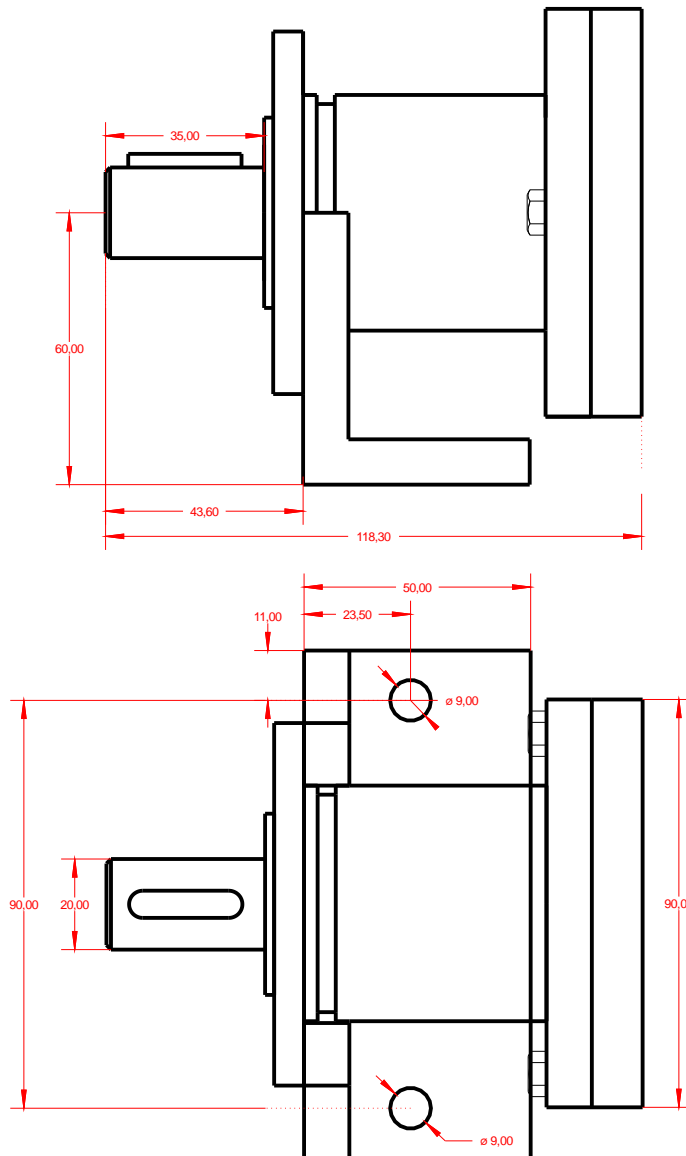

All data in this brochure have an informative character without warranty of characteristics. Changes without previous announcement reserved.